

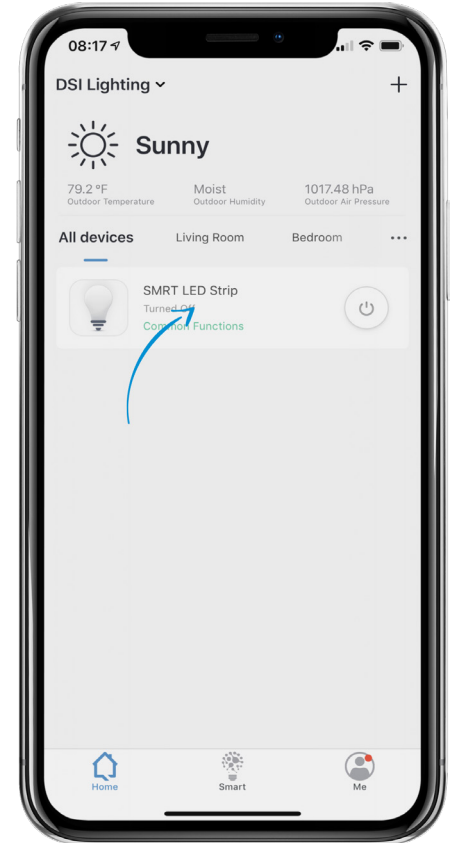

HOW TO SET YOUR LED STRIP TO WHITE AND CONTROL BRIGHTNESS

1. Open the SMRTLite App and select the device you want to control.



2. If the LED strip is off, turn on the LED Strip by pressing the power button at the bottom of the screen.



3. Select the “White” menu option at the top of the screen to change the color to warm white.
4. Your LED Strip should be lit up with warm white color.
5. To control the brightness, slide the brightness slider left and right to reduce or increase the brightness.
6. To turn off the LED Strip, simply press the power button at the bottom of the screen.

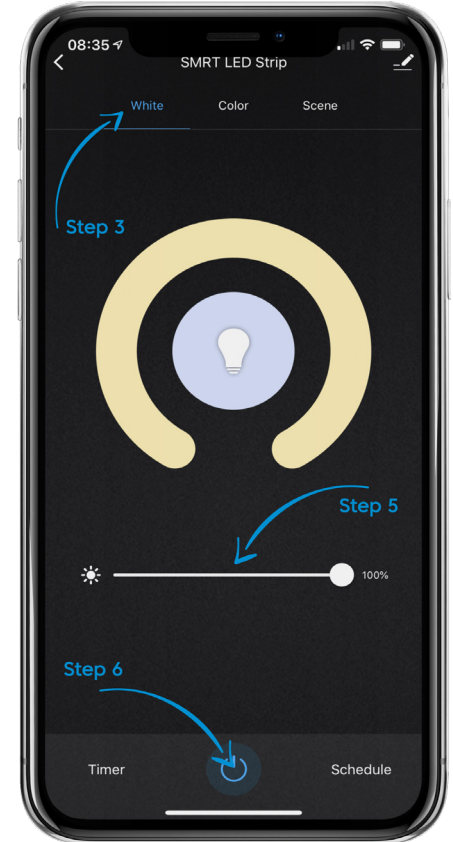

STILL NEED HELP?

Contact us via email at hello@SMRTLite.com
or call us at (800) 388-6141 Ext 216.

Customer Service Hours of Operation

Monday - Friday
9:30AM - 3:00PM EST